

KC2100 Series Urbanus

Direct / Indirect for Strip Fixture Retrofit

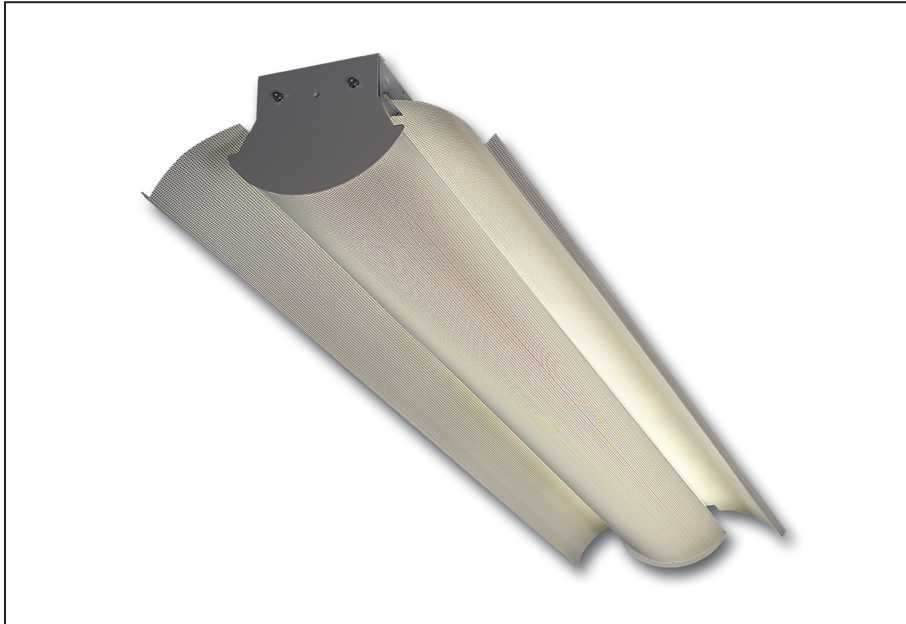

Description

Through the art of perforated metals and modern lines, these easy-to-install kits accommodate different mounting configurations, depending on your needs. No matter which model you choose, you are guaranteed a simple beautiful and cost effective solution with KC2100.

By choosing from reflector types and basket materials, the lighting designer controls the light intensity. The KC2100 can be used to retrofit a flush-mounted strip or a hanging strip.

Features and Benefits

- Perforated metal reflectors and baskets are made of cold rolled steel
- Perforated metal parts are post painted with a durable baked polyester white powder coat
- Each piece is formed by our state-of-the-art multi-radii machine for consistency
- The acrylic basket option provides greater light output while diffusing light for a glare controlled look
- Reflector is used as a ballast cover

Application

Suitable for Retrofitting flush-mounted or hanging strip fixture in commercial, industrial and institutional applications.

Ordering Information

Please call 877-257-5841 for price and delivery.

Notice

Reflector kits do not come with a ballast and are not pre-wired. A.L.P. Lighting Components, Inc., assumes no responsibility for suitability of these materials in any luminaire or application. Please test for fit and function prior to ordering project quantities. Dimensions subject to change without notice.

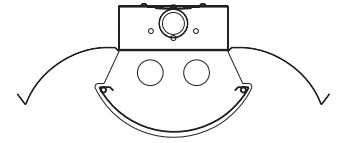

KC2100 Urbanus

Direct / Indirect for Strip Fixture Retrofit

Specifications

Reflector

Perforated
Solid White

Basket

Perforated
Smooth White Lens
Fluted Lens

Socket Plate

Socket conversion kits available to convert a 4-1/4 strip fixture into one- or two-lamp T8

Lighting
Plastics
Solutions
RETROFIT SPECIALISTS

KC2100 Series Urbanus

Direct / Indirect for Strip Fixture Retrofit

Profile Drawing

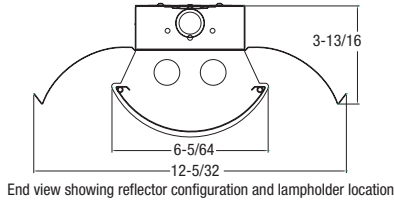

| Catalog Number | Description |
|----------------|---|
| KC21 WPRPB4 | KC2175 White 4' Perf Reflector with Perf Basket Kit |
| KC21 WRPSWA4 | KC2175 White 4' Perf Reflector with Smooth White Lens Kit |
| KC21 WPRFL4 | KC2175 White 4' Perf Reflector with Fluted Lens Kit |
| KC21 WPRPB8 | KC2175 White 8' Perf Reflector with Perf Basket Kit |
| KC21 WPRSWA8 | KC2175 White 8' Perf Reflector with Smooth White Lens Kit |
| KC21 WPRFL8 | KC2175 White 8' Perf Reflector with Fluted Lens Kit |

Basket Options



Smooth White Lens



Fine Fluted Lens



Perforated

Note: Solid white reflector also available. Contact customer service for more details.

KC21 CRM KC2100 Series Continuous Row Mount Kit

Socket Conversion Kits

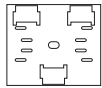

Universal End plate RW 501

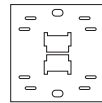

Single Lamp Socket Plate RW 511

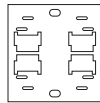

Double Lamp Socket Plate RW 522

Note: All RW 501, RW 511 and RW 522 socket plates use slide-on lampholders. Do not use snap-in lampholders.

Lumen Summary

| ZONE | LUMENS | %LAMP | %LUMINAIRE |
|--------|--------|-------|------------|
| 0-30 | 1202 | 20.7 | 25.6 |
| 0-40 | 1993 | 34.4 | 42.4 |
| 0-60 | 3590 | 61.9 | 76.4 |
| 0-90 | 4646 | 80.1 | 98.8 |
| 40-90 | 2652 | 45.7 | 54.4 |
| 60-90 | 1056 | 18.2 | 22.5 |
| 90-120 | 53 | 0.9 | 1.1 |
| 90-150 | 54 | 0.9 | 1.2 |
| 90-180 | 54 | 0.9 | 1.2 |
| 0-180 | 4700 | 81.0 | 100.0 |

Photometrics

KC21 WRFL4

Direct Luminaire
Solid White Reflector
6" Curved Linear
Prismatic Lens
Lamps (2) F32T8
Rated Lumens: 2900

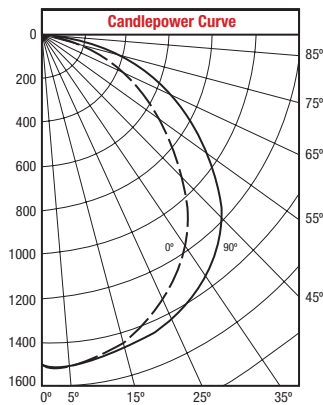

CEILING CAVITY REFLECTANCE

| Room Cavity Ratio | 80 | | | | 70 | | | | 50 | | | | 30 | | | | 10 | | | | 0 |
|-------------------|----|----|----|----|----|----|----|----|----|----|----|----|----|----|----|----|----|----|----|----|----|
| | 70 | 50 | 30 | 10 | 70 | 50 | 30 | 10 | 50 | 30 | 10 | 50 | 30 | 10 | 50 | 30 | 10 | 50 | 30 | 10 | 00 |
| 0 | 96 | 96 | 96 | 96 | 94 | 94 | 94 | 94 | 90 | 90 | 90 | 86 | 86 | 86 | 82 | 82 | 82 | 82 | 82 | 82 | 80 |
| 1 | 88 | 84 | 81 | 77 | 86 | 82 | 79 | 76 | 78 | 76 | 73 | 75 | 73 | 71 | 72 | 70 | 69 | 69 | 67 | 67 | 67 |
| 2 | 81 | 74 | 69 | 64 | 78 | 73 | 68 | 64 | 70 | 66 | 62 | 67 | 63 | 60 | 64 | 61 | 59 | 59 | 57 | 57 | 57 |
| 3 | 74 | 66 | 60 | 55 | 72 | 65 | 59 | 54 | 62 | 57 | 53 | 60 | 56 | 52 | 58 | 54 | 51 | 51 | 49 | 49 | 49 |
| 4 | 68 | 59 | 52 | 47 | 66 | 58 | 51 | 46 | 55 | 50 | 46 | 53 | 49 | 45 | 52 | 48 | 44 | 44 | 42 | 42 | 42 |
| 5 | 63 | 53 | 46 | 40 | 61 | 52 | 45 | 40 | 50 | 44 | 40 | 48 | 43 | 39 | 47 | 42 | 39 | 39 | 37 | 37 | 37 |
| 6 | 58 | 47 | 40 | 35 | 56 | 47 | 40 | 35 | 45 | 39 | 35 | 44 | 38 | 34 | 42 | 38 | 34 | 34 | 32 | 32 | 32 |
| 7 | 54 | 43 | 36 | 31 | 52 | 42 | 36 | 31 | 41 | 35 | 31 | 40 | 34 | 30 | 38 | 34 | 30 | 30 | 28 | 28 | 28 |
| 8 | 50 | 39 | 32 | 27 | 48 | 38 | 32 | 27 | 37 | 31 | 27 | 36 | 31 | 27 | 35 | 30 | 26 | 26 | 25 | 25 | 25 |
| 9 | 46 | 35 | 29 | 24 | 45 | 35 | 28 | 24 | 34 | 28 | 24 | 33 | 28 | 24 | 32 | 27 | 24 | 24 | 22 | 22 | 22 |
| 10 | 42 | 31 | 24 | 20 | 41 | 30 | 24 | 20 | 30 | 24 | 20 | 29 | 23 | 20 | 28 | 23 | 20 | 20 | 18 | 18 | 18 |

Notice
While A.L.P. utilizes IESNA testing procedures and believe our testing results to be accurate, A.L.P. provides photometry for reference only. Actual results will vary based on the actual lamp/ballast combination used, operating temperatures, and other electrical and environmental variables. We urge the customer to perform their own qualification of the fixture before making performance based claims. In no event will we be liable for any loss or damage including without limitation, indirect or consequential loss or damage in connection with the use of this information.

KC2100 06/12

Lighting
Plastics
Solutions
RETROFIT SPECIALISTS

www.mylpsolutions.com

info@mylpsolutions.com

TAMPA BAY

2140 Range Road, Suite A | Clearwater, FL 33765
800-587-3310 | 727-441-9581 | 727-446-2451 fax

CENTRAL FLORIDA

2119 Directors Row, Suite 5 | Orlando, FL 32809
800-682-4197 | 407-398-1001 | 407-398-1003 fax

SOUTHEAST US

3367 W Hospital Avenue, Suite B | Chamblee, GA 30341
800-548-9101 | 770-817-7020 | 770-817-7021 fax

NORTHEAST US

6965 Airport Highway Lane | Pennsauken, NJ 08109
856-661-2442 | 856-661-2447 fax